

**WELDING | GRINDING | DEBURRING | POLISHING | SANDING | THERMAL CUTTING |
DRY DUST | HAZARDOUS DUST | SANDBLASTING | POWDER COATING**

OVERVIEW

The CORAL AIRCOM reverse pulse jet filter system is a highly efficient, self-maintaining filter for dust with a fully automatic cleaning system which uses compressed air.

The unit is manufactured from individual, reinforced steel panels which allows for extremely robust construction. The design incorporates an upper chamber which houses the compressed air cleaning system, the center section which includes the sleeve style filters and a lower section with the supporting legs, hopper and dirty air inlet.

WORKING PRINCIPLE

The contaminated air enters the Coral AIRCOM inlet hopper located at the bottom of the unit. Due to the large open area of the hopper there is a decrease in air velocity which allows the larger particles to drop out into a portable waste bin which is equipment with wheels.

As an option for applications with a high volume of solids, a special pre-chamber (CC) can be added to aid in the removal of solids. Optional rotary valves and worm conveyors (CVS) are also available to help remove collected solids.

REVERSE PULSE CLEANING

The Coral AIRCOM is always running at peak efficiency due to the reverse jet cleaning system which is electronically controlled by our Coral controller. A pressure sensing switch is always monitoring the pressure loss through the filter sleeves and activates a cleaning cycle utilizing compressed air which cleans one row of filter sleeves at a time. This method of automatic cleaning allows for a continuous air flow that is not affected by the cleaning cycles.

AIRCOM

Dust & Fume collector with fully automated reverse pulse cleaning



OPERATING PRINCIPLE

LEGEND



Clean air



Air with dust

AIRCOM

WITH BINS

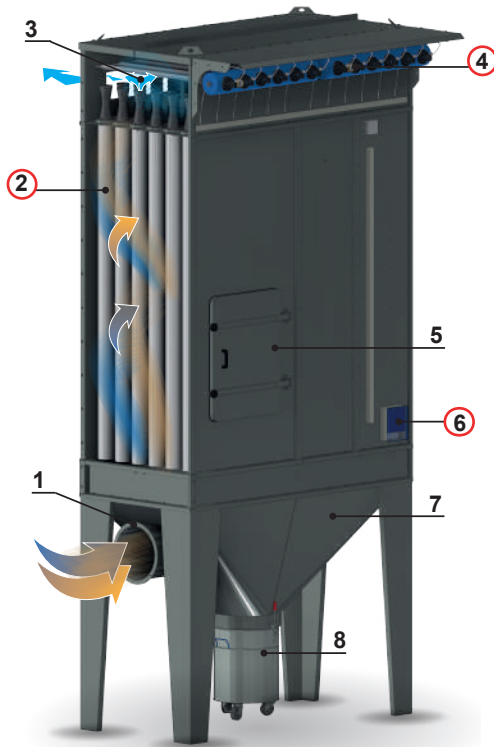

AIRCOM CVS

WITH SCREW CONVEYOR AND ROTARY VALVE

Always add the rotary valve according to our technical office suggestions.

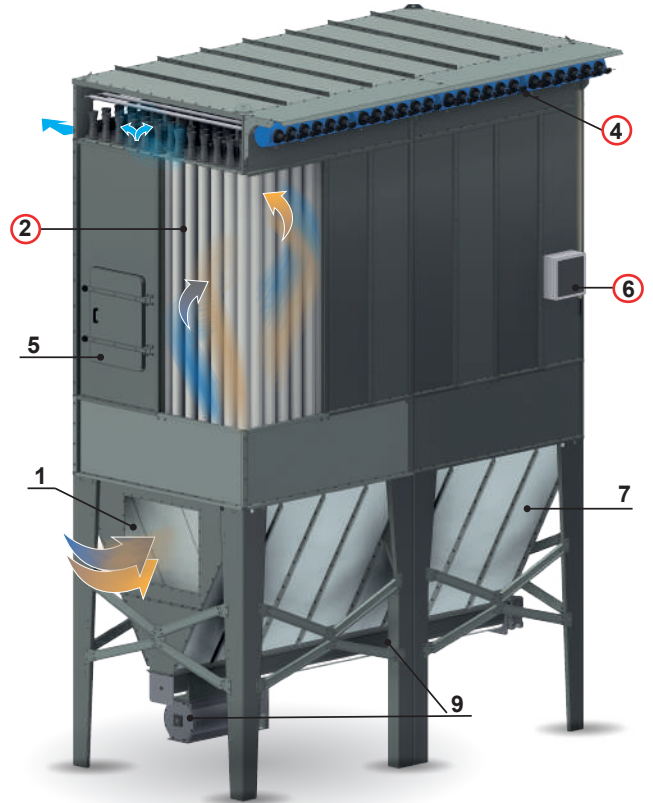

OPTIONALS

- 10 Fan
- 11 Automatic or manual fire extinguishing system
- 12 Legs extension
- 13 Soundproofed box with maintenance door
- 14 Compressed air tank box with heaters
- 15 Rotary star valve (standard in CVS models) VS model
- 16 Stair and balcony
- 17 External pre-chamber

AIRCOM CC CVS

CVS PLUS SETTING CHAMBER

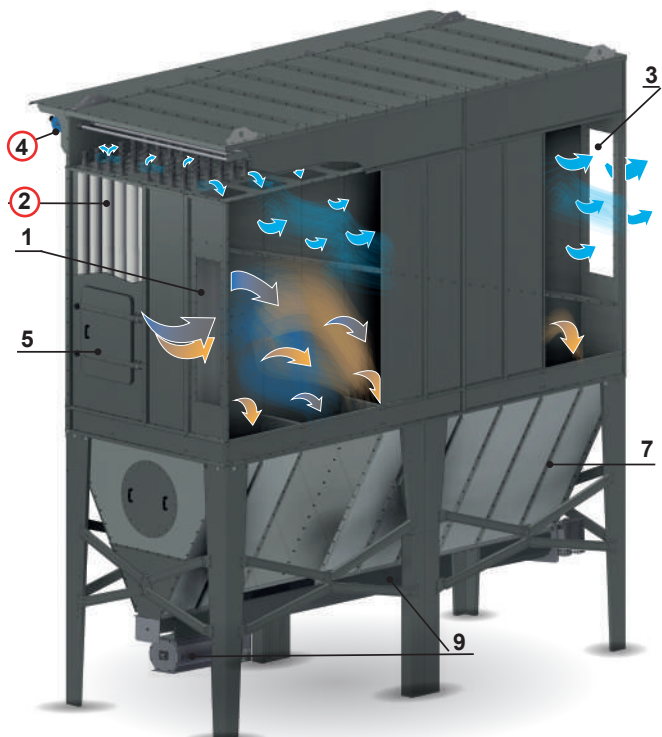

AIRCOM VS

WITH HOPPER AND ROTARY VALVE

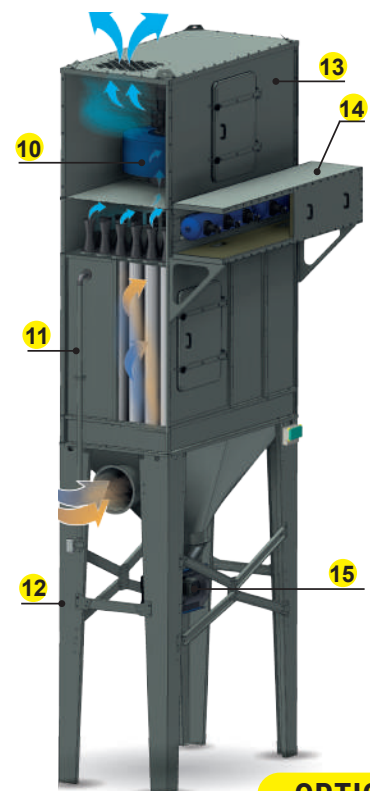

OPTIONALS



FILTERING SLEEVE

STANDARD	
	PES 500 A
M CLASS	polyester
OPTIONALS	
	PES 500/TF
M CLASS	polyester/PTFE coating
	PES 550/AX/EXAM ACCREDITED
M CLASS	polyester/aluminum coated/antistatic
	NOMEX
	meta-aramid fiber



Filtering sleeve model choice could affect various parameters.



MEMBRANE ELECTRO VALVE: two way valve normally closed; it is activated by an electric solenoid. It holds air pressure of max. 6 bar. The compressed air tank operates at 4 to 6 bar.

	AIRCOM 36-48-50-72- 108	AIRCOM 96-100-144-150- 200-216-250-288- 350-360-400-432- 504-576
SOLENOID VALVE MODEL	SP 25	SP 40
GAS FITTINGS (IN)	1	1 ½
PRESSURE (PSI)	87	
MAX FLUID TEMPERATURE (°F)	176	176
VOLTAGE (V)	24 AC	24 AC
FREQUENCY (HZ)	60	60
POWER ABSORBED (V)	19 AC 15 DC	19 AC 15 DC
PROTECTION RATING	IP 65	IP 65
DEGREE OF PURITY OF COMPRESSED AIR	ISO 8573-1 3	ISO 8573-1 3



CYCLIC PROGRAMMER WITH PRESSURE DROP CONTROL (PLC): a sealed container is used with a transparent lid, duration of injection and pause phases are preset but easily changeable.

IN/OUT VOLTAGE	230 V / 24VAC
MAXIMUM CHARGING POWER	20VA pulse
TEMPERATURE RANGE	-5°F ÷ +122°F
DISPLAY	5 LEDs h 0,5 inches
PROTECTION RATING	IP65
DP CONTROL	Internal transducer 0=10 kPa
DIMENSIONS (INCHES)	9 x 7 x 4
TERMINAL BOARD	2.5 mm ² 250VAC



AIRCOM

TECHNICAL FEATURES

STANDARD CONFIGURATION

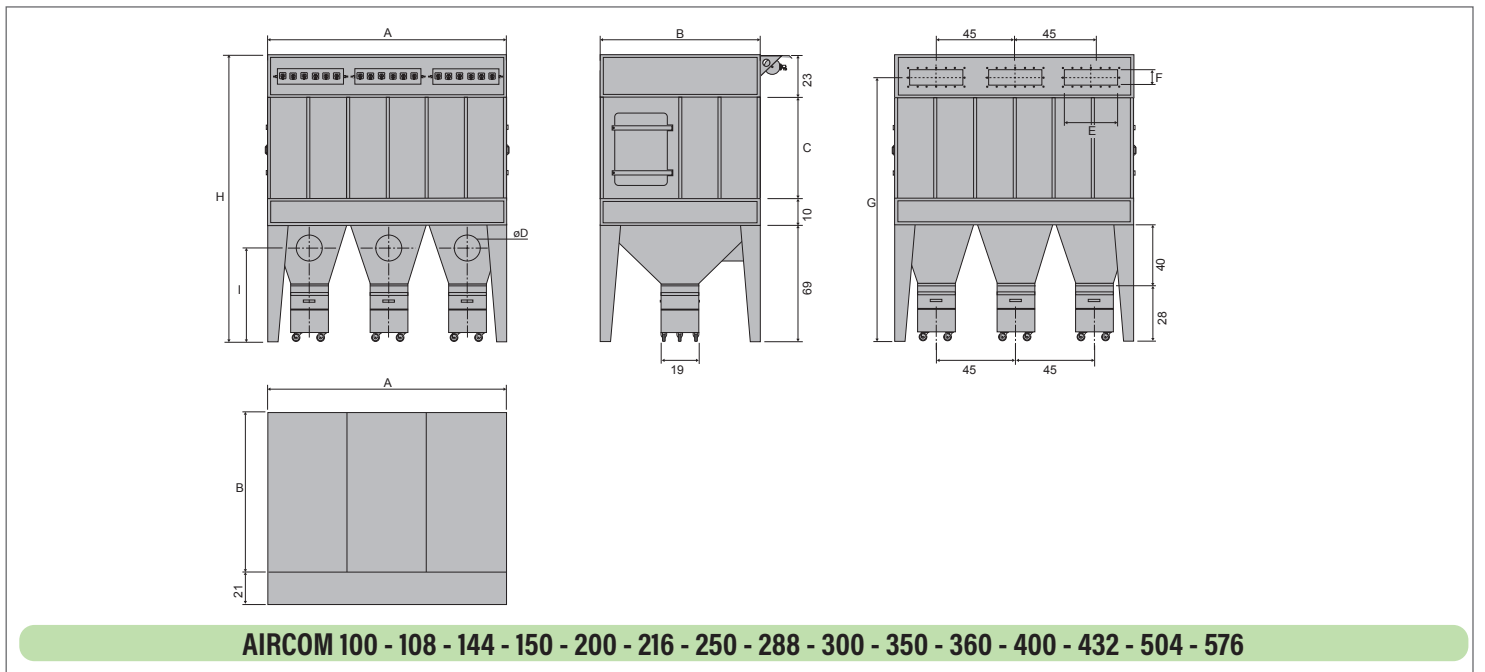
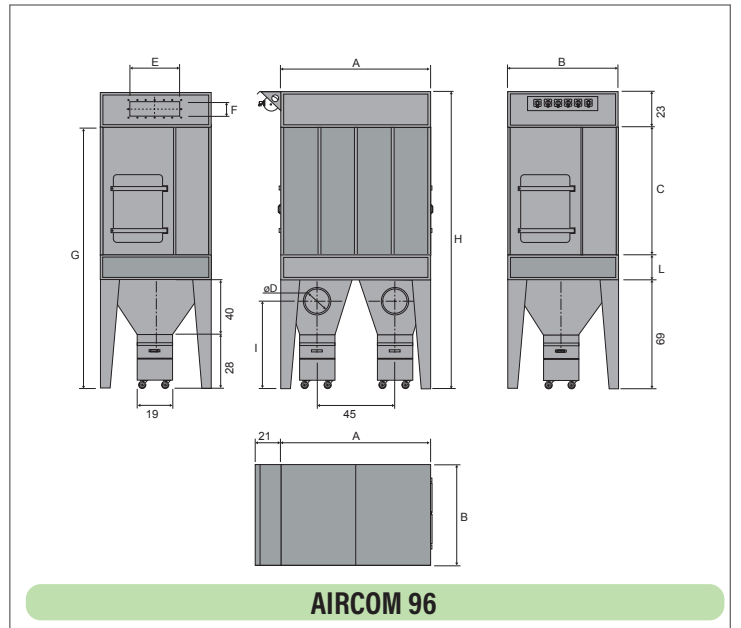
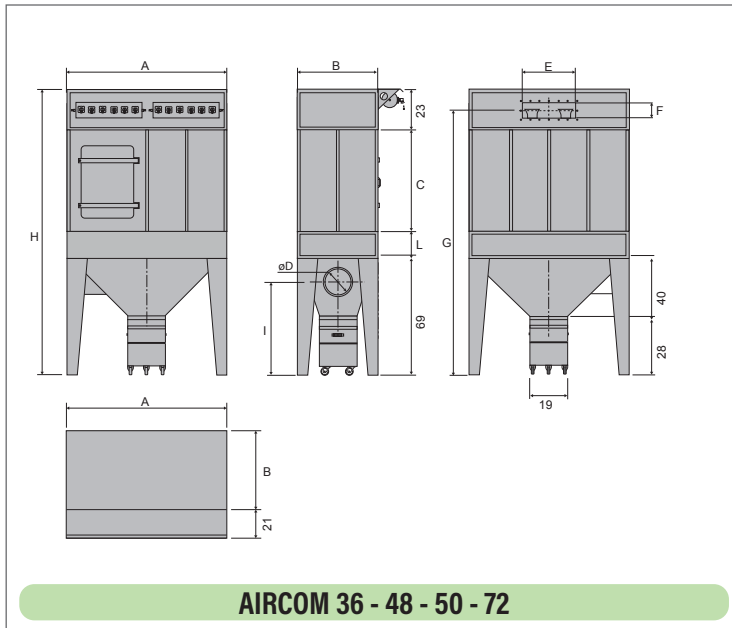
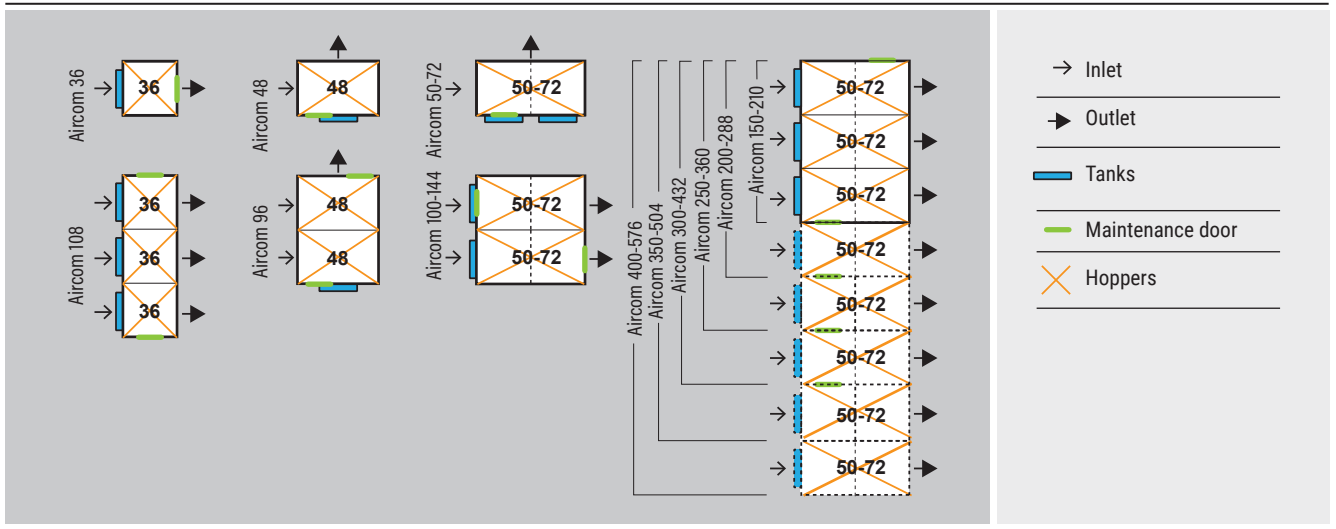

AIRCOM CVS

TECHNICAL FEATURES

STANDARD CONFIGURATION

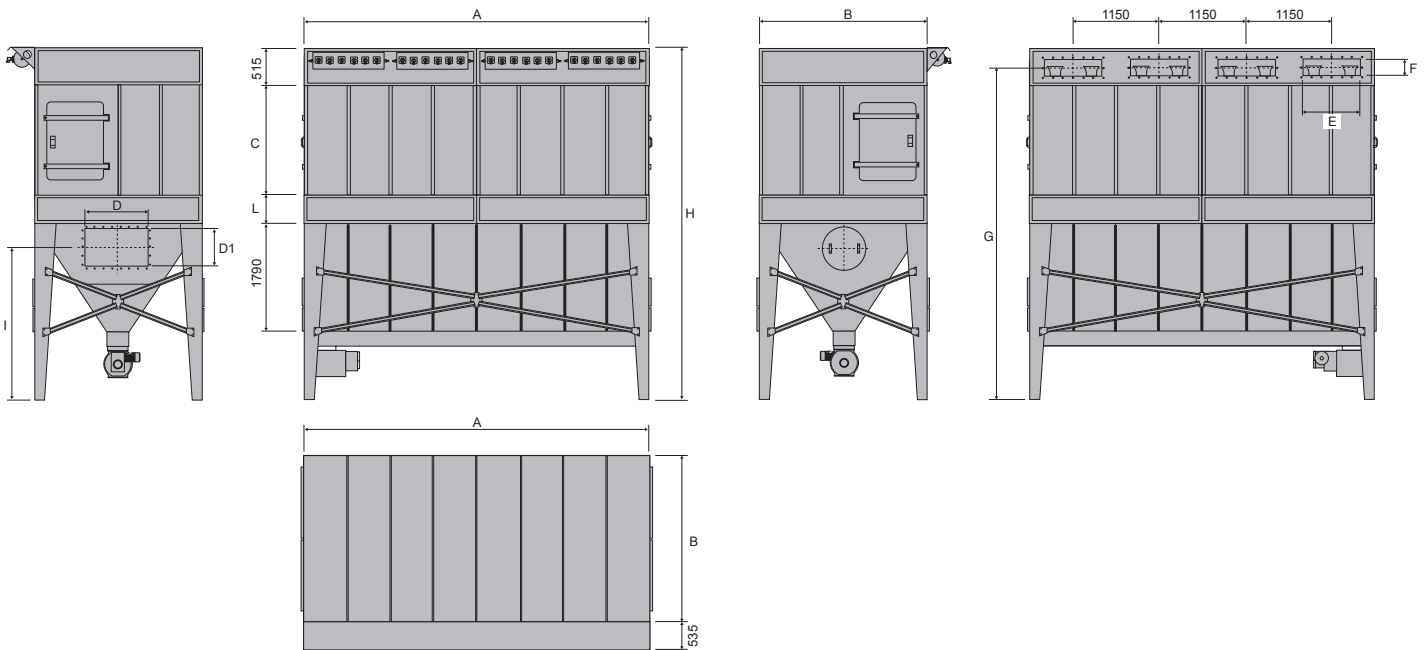
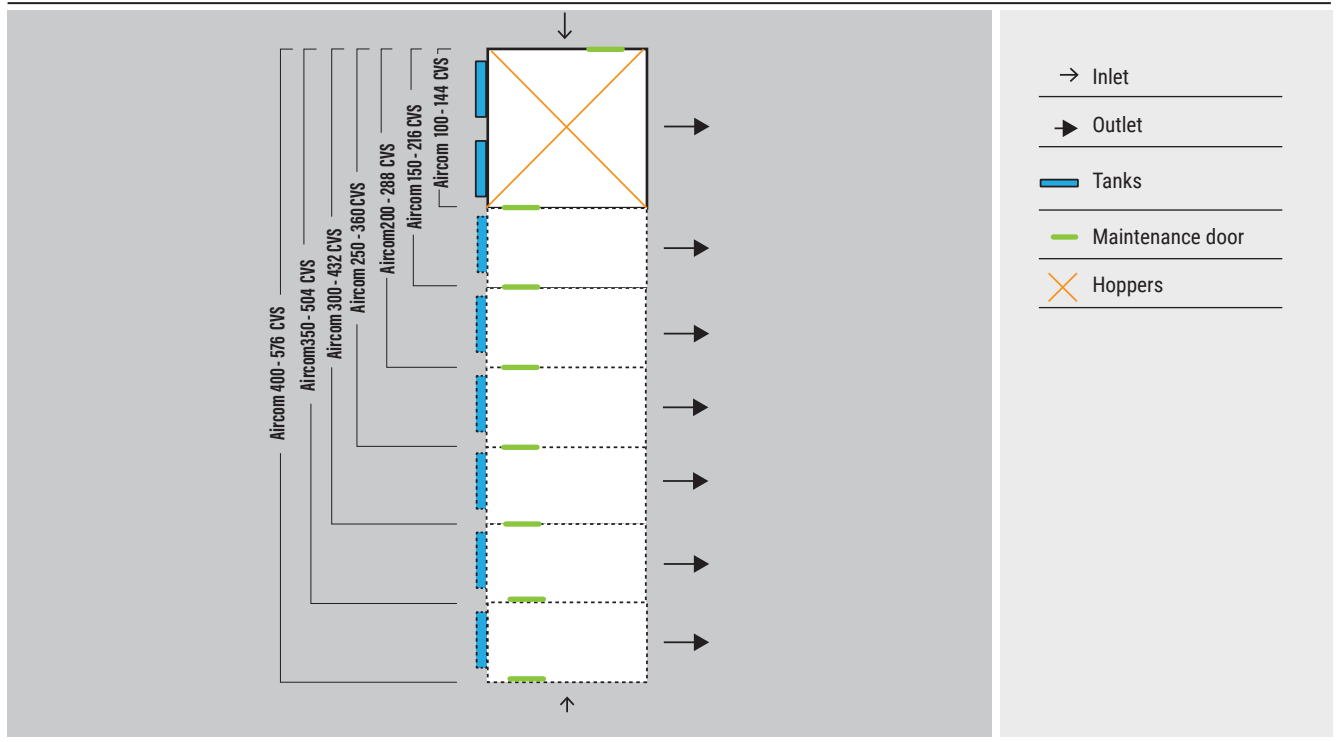

AIRCOM CVS 100 - 144 - 150 - 200 - 216 - 250 - 288 - 300 - 350 - 360 - 400 - 432 - 504 - 576

AIRCOM CVS



- Version with screw conveyor and rotary valve.

	DIMENSIONS (inches)												SLEEVES				PNEUMATIC CLEANING		
	Filter							Inlet		Outlet		Max air flow	Ø	H	N°	Filtering surface	N° tanks	Air volume	Valves
	A	B	C	G	H	I	L	N°	DxD1	N°	ExF	cfm				sq.ft	N° x Ø	gal	N° x Ø
AIRCOM 144 - 2,0 CVS	90	90	125	167	226	95	10	1	39 x 31	2	27 x 8	8357	5 inches	78	144	1173	2 x Ø8"	10,12	12x1" ½
AIRCOM 144 - 2,5 CVS	90	90	145	187	246	95	10	1	39 x 31	2	27 x 8	10376		98	144	1463	2 x Ø8"	10,12	12x1" ½
AIRCOM 144 - 3,0 CVS	90	90	165	206	265	95	29	1	39 x 31	2	27 x 8	12454		118	144	1754	2 x Ø8"	10,12	12x1" ½
AIRCOM 216 - 2,0 CVS	135	90	125	167	226	95	10	1	39 x 31	3	27 x 8	12360		78	216	1743	3 x Ø8"	10,12	18x1" ½
AIRCOM 216 - 2,5 CVS	135	90	145	187	246	95	10	1	39 x 31	3	27 x 8	15567		98	216	2185	3 x Ø8"	10,12	18x1" ½
AIRCOM 216 - 3,0 CVS	135	90	165	206	265	95	29	1	39 x 31	3	27 x 8	18681		118	216	2626	3 x Ø8"	10,12	18x1" ½
AIRCOM 288 - 2,5 CVS	181	90	145	187	246	95	10	1	39 x 31	4	27 x 8	20753		98	288	2917	4 x Ø8"	10,12	24x1" ½
AIRCOM 288 - 3,0 CVS	181	90	165	206	265	95	29	1	39 x 31	4	27 x 8	24910		118	288	3509	4 x Ø8"	10,12	24x1" ½
AIRCOM 360 - 2,5 CVS	0,13	90	145	187	246	95	10	1	39 x 31	5	27 x 8	25944		98	360	3648	5 x Ø8"	10,12	30x1" ½
AIRCOM 360 - 3,0 CVS	226	90	165	206	265	95	29	1	39 x 31	5	27 x 8	31135		118	360	4380	5 x Ø8"	10,12	30x1" ½
AIRCOM 432 - 2,5 CVS	271	90	145	187	246	95	10	1	39 x 31	6	27 x 8	31224		98	432	4391	6 x Ø8"	10,12	36x1" ½
AIRCOM 432 - 3,0 CVS	271	90	165	206	265	95	29	1	39 x 31	6	27 x 8	37362		118	432	5231	6 x Ø8"	10,12	36x1" ½
AIRCOM 504 - 2,5 CVS	316	90	145	187	246	95	10	1	39 x 31	7	27 x 8	36462		98	504	5123	7 x Ø8"	10,12	42x1" ½
AIRCOM 504 - 3,0 CVS	316	90	165	206	265	95	29	1	39 x 31	7	27 x 8	44702		118	504	6103	7 x Ø8"	10,12	42x1" ½
AIRCOM 576 - 2,5 CVS	362	90	145	187	246	95	10	1	39 x 31	8	27 x 8	41671		98	576	5855	8 x Ø8"	10,12	48x1" ½
AIRCOM 576 - 3,0 CVS	362	90	165	206	265	95	29	1	39 x 31	8	27 x 8	48823		118	576	6975	8 x Ø8"	10,12	48x1" ½

REDUCED SLEEVES QUANTITY

	A	B	C	G	H	I	L	N°	DxD1	N°	ExF	cfm	Ø	H	N°	sq.ft	N° x Ø	gal	N° x Ø
AIRCOM 100 - 2,0 CVS	90	90	125	167	226	95	10	1	39 x 31	2	27 x 8	5803							
AIRCOM 100 - 2,5 CVS	90	90	145	187	246	95	10	1	39 x 31	2	27 x 8	7210	98	100	1011	2 x Ø8"	10,12	10x1" ½	
AIRCOM 100 - 3,0 CVS	90	90	165	206	265	95	29	1	39 x 31	2	27 x 8	8828	118	100	1194	2 x Ø8"	10,12	10x1" ½	
AIRCOM 150 - 2,0 CVS	135	90	125	167	226	95	10	1	39 x 31	3	27 x 8	8710	78	150	1216	3 x Ø8"	10,12	15x1" ½	
AIRCOM 150 - 2,5 CVS	135	90	145	187	246	95	10	1	39 x 31	3	27 x 8	10829	98	150	1517	3 x Ø8"	10,12	15x1" ½	
AIRCOM 150 - 3,0 CVS	135	90	165	206	265	95	29	1	39 x 31	3	27 x 8	13243	118	150	1797	3 x Ø8"	10,12	15x1" ½	
AIRCOM 200 - 2,0 CVS	181	90	125	167	226	95	10	1	39 x 31	4	27 x 8	11606	78	200	1614	4 x Ø8"	10,12	20x1" ½	
AIRCOM 200 - 2,5 CVS	181	90	145	187	246	95	10	1	39 x 31	4	27 x 8	14420	98	200	2023	4 x Ø8"	10,12	20x1" ½	
AIRCOM 200 - 3,0 CVS	181	90	165	206	265	95	29	1	39 x 31	4	27 x 8	17657	118	200	2389	4 x Ø8"	10,12	20x1" ½	
AIRCOM 250 - 2,5 CVS	226	90	145	187	246	95	10	1	39 x 31	5	27 x 8	18010	98	250	2529	5 x Ø8"	10,12	25x1" ½	
AIRCOM 250 - 3,0 CVS	226	90	165	206	265	95	29	1	39 x 31	5	27 x 8	22071	118	250	3024	5 x Ø8"	10,12	25x1" ½	
AIRCOM 300 - 2,5 CVS	271	90	145	187	246	95	10	1	39 x 31	6	27 x 8	21541	98	360	3024	6 x Ø8"	10,12	30x1" ½	
AIRCOM 300 - 3,0 CVS	271	90	165	206	265	95	29	1	39 x 31	6	27 x 8	25897	118	360	3638	6 x Ø8"	10,12	30x1" ½	
AIRCOM 350 - 2,5 CVS	316	90	145	187	246	95	10	1	39 x 31	7	27 x 8	25191	98	360	3530	7 x Ø8"	10,12	35x1" ½	
AIRCOM 350 - 3,0 CVS	316	90	165	206	265	95	29	1	39 x 31	7	27 x 8	30270	118	360	4240	7 x Ø8"	10,12	35x1" ½	
AIRCOM 400 - 2,5 CVS	362	90	145	187	246	95	10	1	39 x 31	8	27 x 8	28899	98	432	4036	8 x Ø8"	10,12	40x1" ½	
AIRCOM 400 - 3,0 CVS	362	90	165	206	265	95	29	1	39 x 31	8	27 x 8	34578	118	432	4843	8 x Ø8"	10,12	40x1" ½	

AIRCOM CC-CVS

DATI TECNICI | CARACTERISTIQUES TECHNIQUES | TECHNICAL FEATURES | TECHNISCHE DATEN | CARACTERÍSTICAS TÉCNICAS

CONFIGURAZIONI STANDARD
 CONFIGURATION STANDARD
 STANDARD CONFIGURATION
 CONFIGURACIONES STANDARD
 STANDARDKONFIGURATION

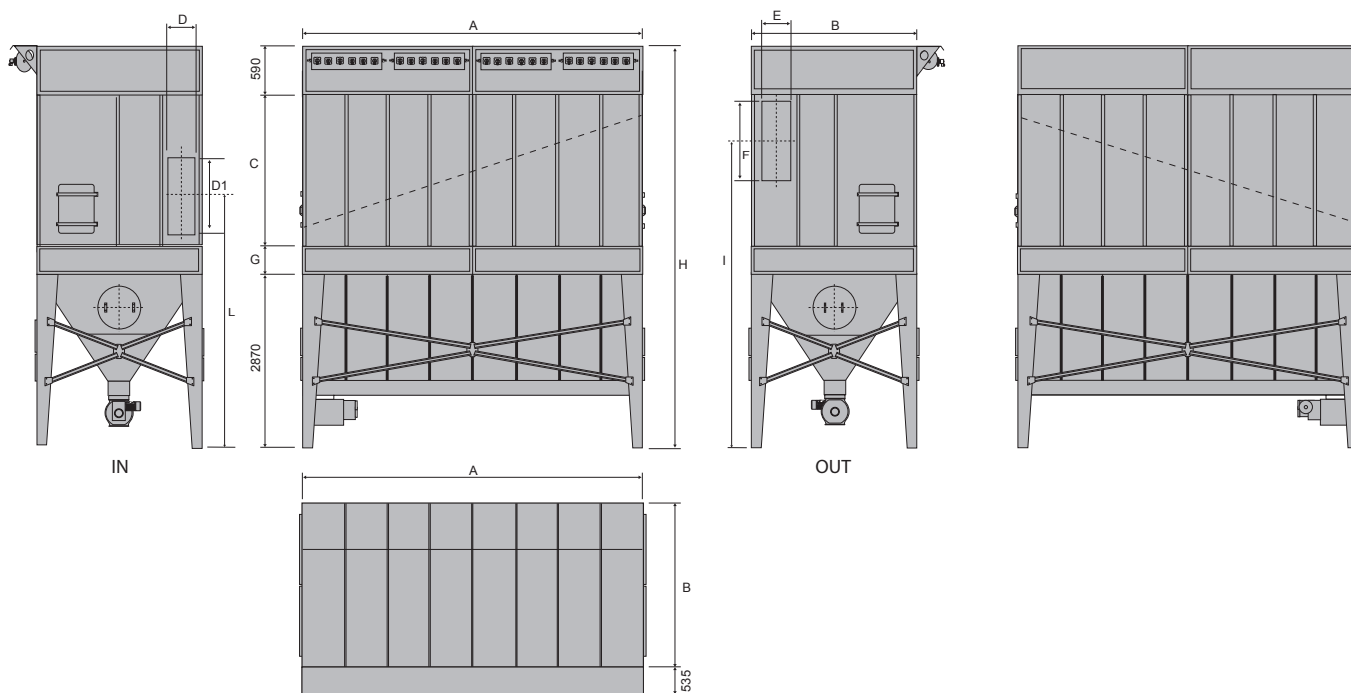
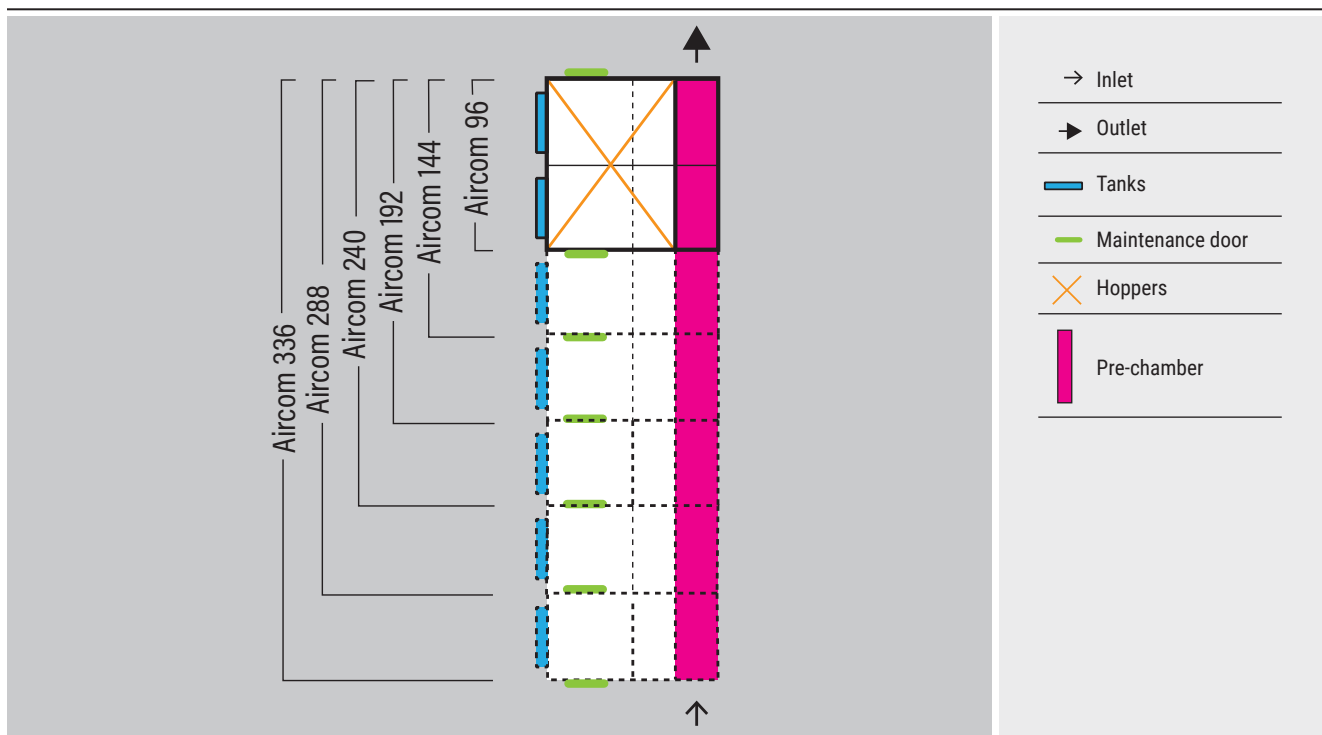

AIRCOM CC CVS 96 - 144 - 192 - 240 - 288 - 336

AIRCOM CC-CVS



- Version CVS plus setting chamber.

	DIMENSIONS (inches)										
	Filter							Inlet		Outlet	
	A	B	C	G	H	I	L	N°	DxD1	N°	ExF
AIRCOM 96 - 2,0 CC-CVS	90	90	78	10	226	172	152	1	13 x 23	1	13 x 23
AIRCOM 96 - 2,5 CC-CVS	90	90	98	10	246	181	162	1	13 x 23	1	13 x 23
AIRCOM 96 - 3,0 CC-CVS	90	90	98	29	265	201	181	1	13 x 23	1	13 x 23
AIRCOM 144 - 2,0 CC-CVS	135	90	78	10	226	168	152	1	13 x 35	1	13 x 35
AIRCOM 144 - 2,5 CC-CVS	135	90	98	10	246	181	162	1	13 x 35	1	13 x 35
AIRCOM 144 - 3,0 CC-CVS	135	90	98	29	265	201	181	1	13 x 35	1	13 x 35
AIRCOM 192 - 2,0 CC-CVS	181	90	78	10	226	172	148	1	13 x 43	1	13 x 43
AIRCOM 192 - 2,5 CC-CVS	181	90	98	10	246	181	158	1	13 x 43	1	13 x 43
AIRCOM 192 - 3,0 CC-CVS	181	90	98	29	265	201	177	1	13 x 43	1	13 x 43
AIRCOM 240 - 2,0 CC-CVS	226	90	78	10	226	168	156	1	13 x 59	1	13 x 59
AIRCOM 240 - 2,5 CC-CVS	226	90	98	10	246	181	166	1	13 x 59	1	13 x 59
AIRCOM 240 - 3,0 CC-CVS	226	90	98	29	265	201	185	1	13 x 59	1	13 x 59
AIRCOM 288 - 2,0 CC-CVS	271	90	78	10	226	168	156	1	13 x 59	1	13 x 59
AIRCOM 288 - 2,5 CC-CVS	271	90	98	10	246	181	166	1	13 x 59	1	13 x 59
AIRCOM 288 - 3,0 CC-CVS	271	90	98	29	265	201	185	1	13 x 59	1	13 x 59
AIRCOM 336 - 2,5 CC-CVS	316	90	98	10	246	192	187	1	15 x 86	1	15 x 86
AIRCOM 336 - 3,0 CC-CVS	316	90	98	29	265	212	207	1	15 x 86	1	15 x 86

	Max air flow	SLEEVES				PNEUMATIC CLEANING		
		Filtering surface		N° tanks	Air volume	Valves		
		∅	H inch				N°	sq.ft
AIRCOM 96 - 2,0 CC-CVS	6980	5 inches	78	96	796	2x 06"	5,76	12x 1"
AIRCOM 96 - 2,5 CC-CVS	8181		98	96	1001	2x 06"	5,76	12x 1"
AIRCOM 96 - 3,0 CC-CVS	9164		118	96	1194	2x 06"	5,76	12x 1"
AIRCOM 144 - 2,0 CC-CVS	10476		78	144	1194	3x 06"	5,76	18x 1"
AIRCOM 144 - 2,5 CC-CVS	12271		98	144	1496	3x 06"	5,76	18x 1"
AIRCOM 144 - 3,0 CC-CVS	13749		118	144	1797	3x 06"	5,76	18x 1"
AIRCOM 192 - 2,0 CC-CVS	13966		78	192	1593	4x 06"	5,76	24x 1"
AIRCOM 192 - 2,5 CC-CVS	16368		98	192	1991	4x 06"	5,76	24x 1"
AIRCOM 192 - 3,0 CC-CVS	18328		118	192	2389	4x 06"	5,76	24x 1"
AIRCOM 240 - 2,0 CC-CVS	17457		78	240	1991	5x 08"	5,76	30x 1"
AIRCOM 240 - 2,5 CC-CVS	20458		98	240	1497	5x 08"	5,76	30x 1"
AIRCOM 240 - 3,0 CC-CVS	22913		118	240	2992	5x 08"	5,76	30x 1"
AIRCOM 288 - 2,0 CC-CVS	20953		78	288	2389	6x 06"	5,76	36x 1"
AIRCOM 288 - 2,5 CC-CVS	24547		98	288	2992	6x 06"	5,76	36x 1"
AIRCOM 288 - 3,0 CC-CVS	31430		118	288	3595	6x 06"	5,76	36x 1"
AIRCOM 336 - 2,5	28640		98	576	3498	7x 08"	5,76	42x 1"
AIRCOM 336 - 3,0	32018		118	576	4176	7x 08"	5,76	42x 1"

INSTALLATION EXAMPLES

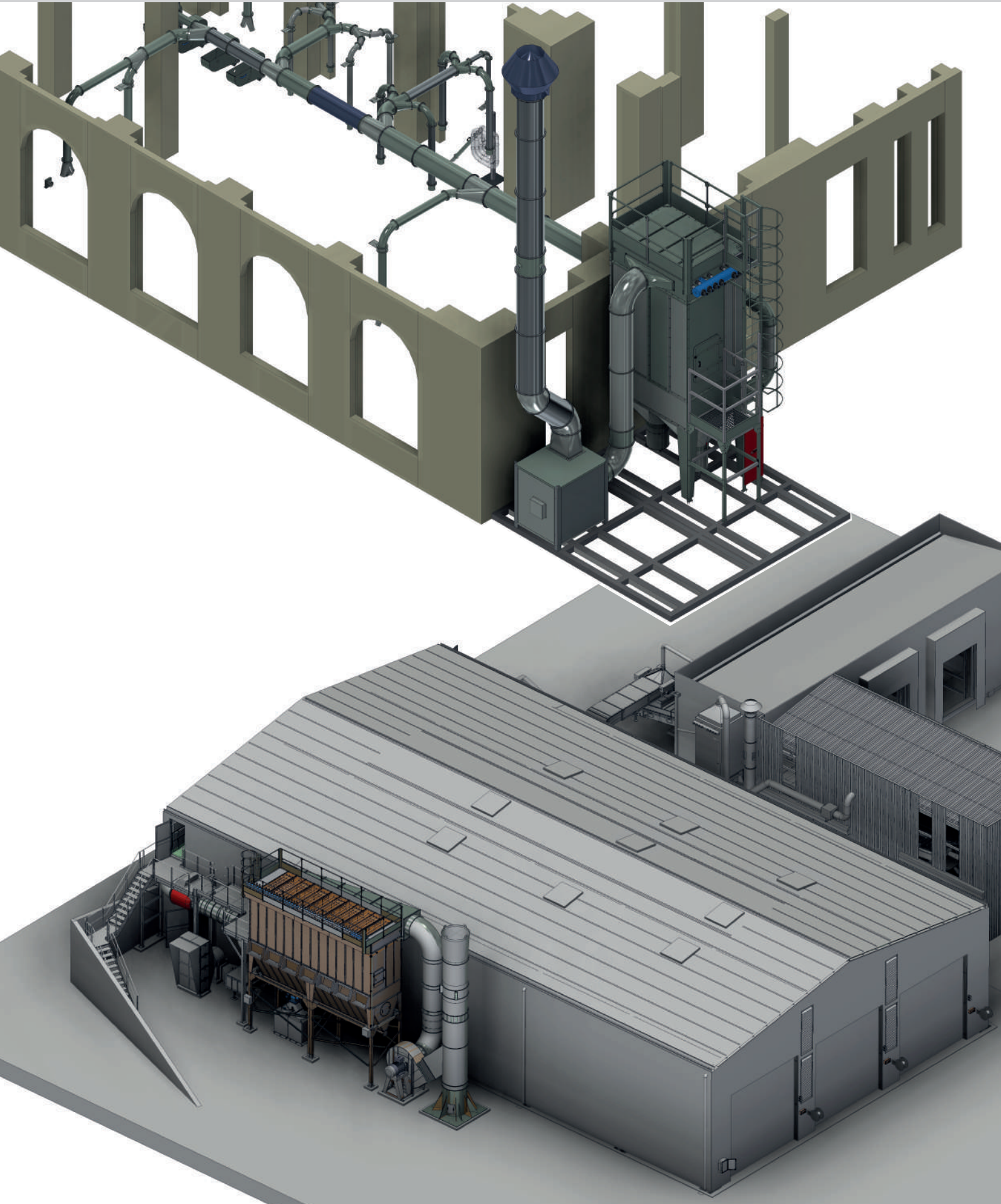

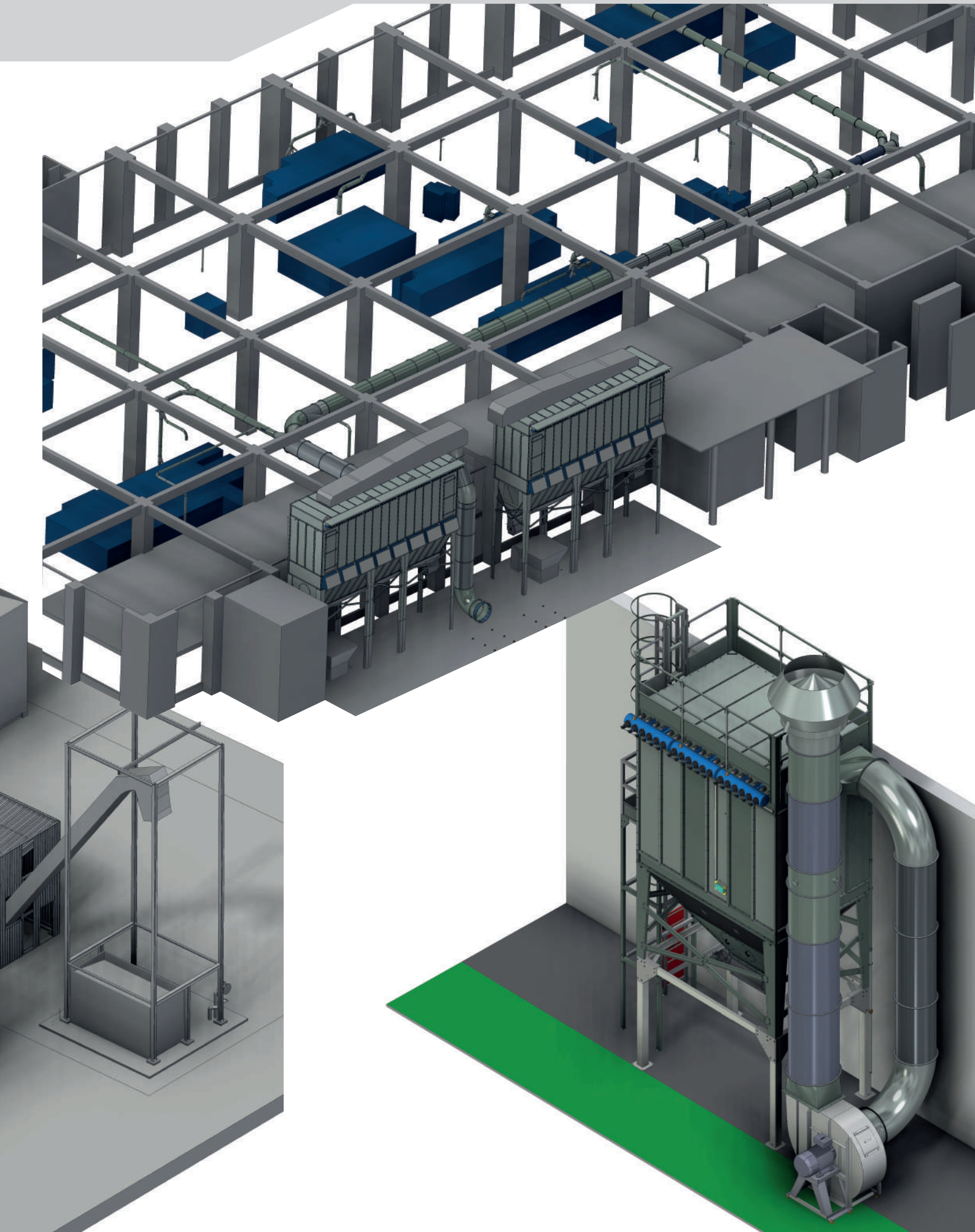

AIRCOM



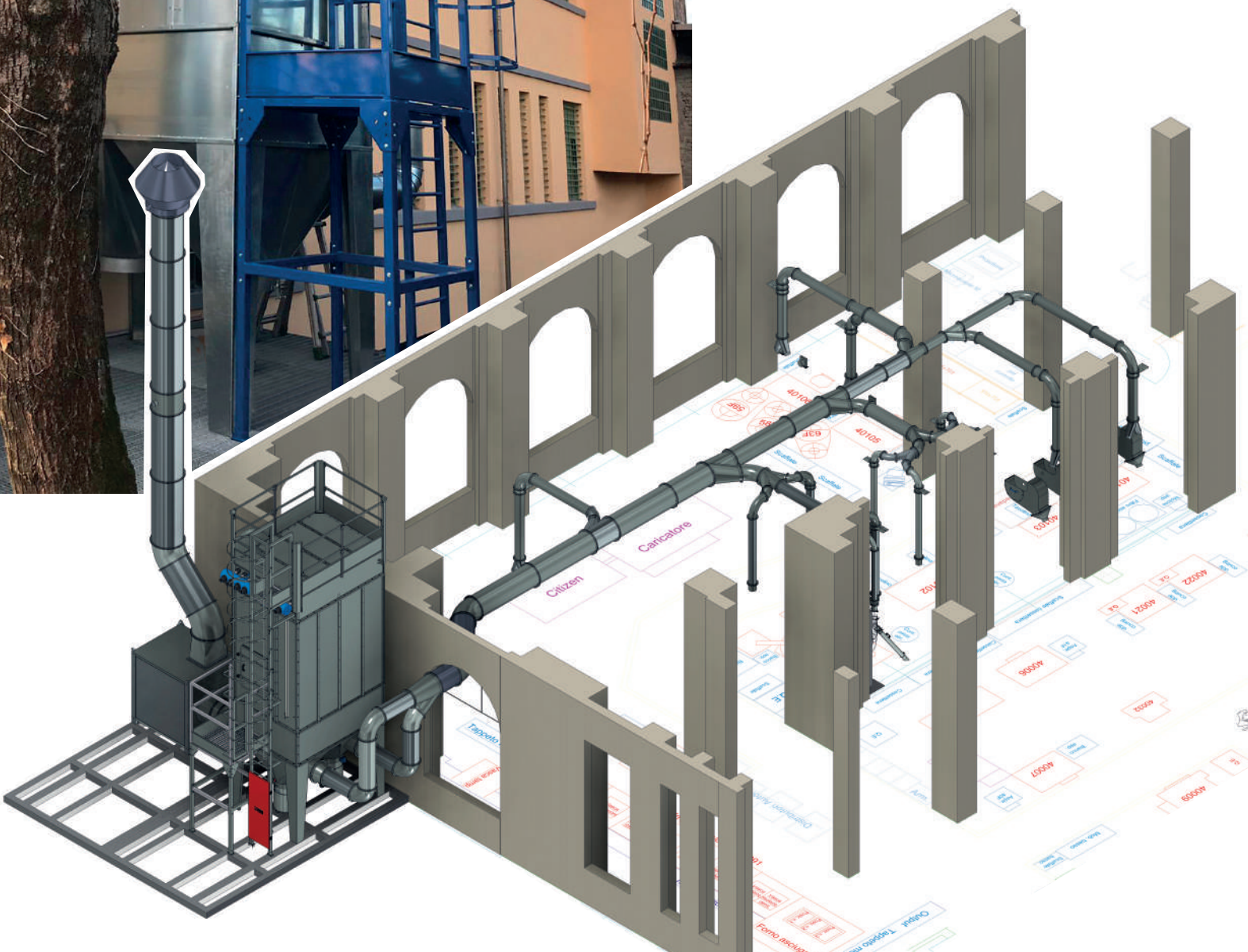

AIRCOM

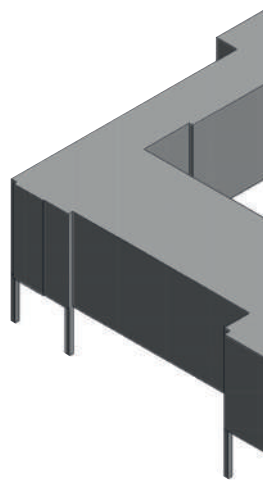

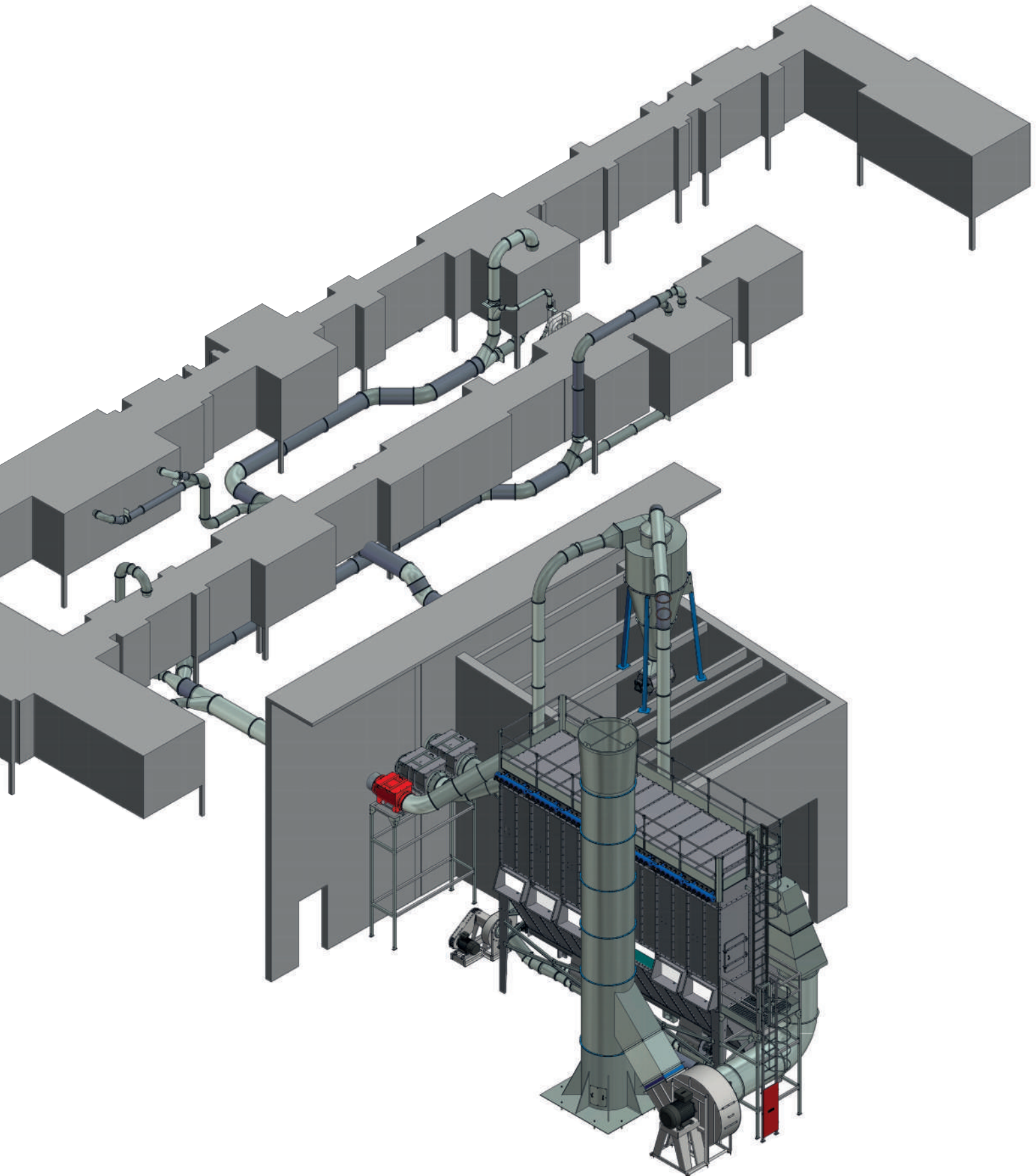

coralnorthamerica.com



CORAL USA CORP.
19121 Marketplace Avenue, Bldg. 1 Suite 165 KYLE, TX 78640, United States of America
Cell: +1 480 796 5352 E: info@coral.us www.coralnorthamerica.com